

Information  
Dossier

# *CONVERTIBLE SUITCASE*

LAURA CAMPMANY



Information  
Dossier  
*CONVERTIBLE  
SUITCASE*

# Presentation

The suitcase is a fundamental element in any trip. Despite the wide variety of styles, sizes, and materials available in the market, **current suitcases remain a simple container** that we have to place on some surface and then stack inside and try to organize in some way the items, garments, or accessories that will accompany us.

Those who travel frequently, or those who engage in business or cultural tourism with short stays and multiple destinations, know well that luggage management, with its constant packing and unpacking, along with the effort involved in finding the right place for everything in the hotel room (and its subsequent retrieval), can become a tedious and extremely stressful task

**Crafted with a clear vision, our product aims to transform the conventional suitcase into a convenient wardrobe on-the-go, ensuring your garments stay neatly hung and wrinkle-free, while also providing impeccable organization and safeguarding your belongings from loss or oversight.**



*Comfort and efficiency during your trips.*

*Say goodbye to chaos and wrinkled attire with our innovative suitcase, which effortlessly converts into a wardrobe. Ensure your belongings are neatly organized, well-protected, and readily available throughout your journey.*

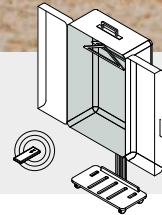

**Information Dossier**  
**CONVERTIBLE SUITCASE**

# How it Works



To tackle the mentioned common issues, the convertible suitcase or "**trimaleta**" offers precisely that—a transformation into a convenient, elevating wardrobe.

- 1 With its remote control feature, the convertible suitcase rises above its wheeled base, granting easy access without the need to bend down.
- 2 Once elevated, we enter the code to unlock the locking system and open it, revealing its two wardrobe-style doors.

Upon opening, a main compartment awaits where clothes are neatly hung. Additionally, on each side, there are three-tiered shelves, ideal for storing various accessories like toiletry bags, first aid kits, bags of underwear, and more.

- |                            |                    |
|----------------------------|--------------------|
| 1. Convertible suitcase    | 6. Hanger bar      |
| 2. Main Compartment        | 7. Remote control  |
| 3. Doors with compartments | 8. Base            |
| 4. Handle                  | 9. Four wheels     |
| 5. Lock system             | 10. Lifting system |

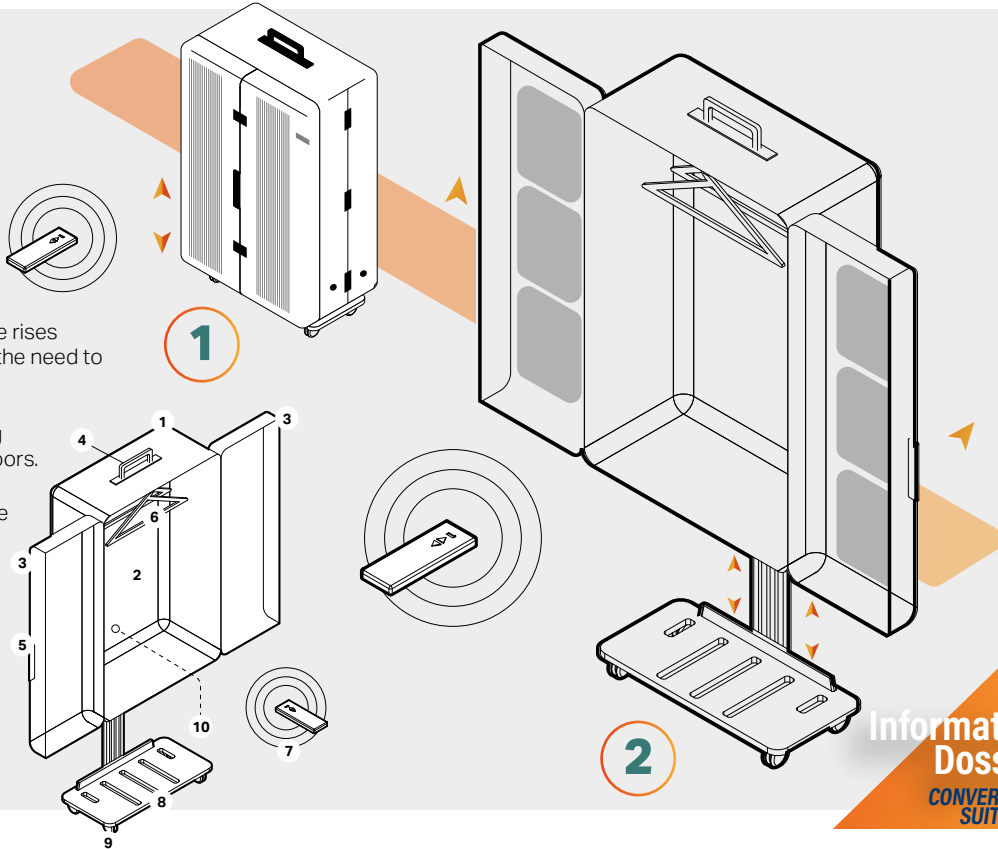

2

Information  
Dossier  
CONVERTIBLE  
SUITCASE

# Benefits

The trimaleta represents an innovative option that combines the functionality of a travel suitcase with the convenience of a portable wardrobe. Some of its benefits include:



**Enhanced organization:** The trimaleta enables efficient organization of clothes and belongings, allowing garments to be hung separately from other items, each occupying its designated compartment.



**Space-saving:** Traveling with your own wardrobe eliminates the need to rearrange belongings. This feature proves invaluable in accommodations with limited storage space, such as small hotel rooms or temporary lodgings.



**Wrinkle prevention:** Hanging clothes in the trimaleta prevents them from wrinkling during travel, particularly beneficial for delicate or formal attire that needs to remain impeccable.



**Improved accessibility:** Having clothes hung in the trimaleta facilitates easy access compared to extracting them from a conventional suitcase. You can quickly locate desired items without rummaging through the contents.



■ *In conclusion, this suitcase that transforms into a wardrobe is the solution for maintaining organized, protected, and easily accessible luggage during trips. It's the ideal choice for those who prioritize comfort and efficiency while on the move.*



**Information  
Dossier**  
CONVERTIBLE  
SUITCASE